

Moderate pressure, very high volume double acting grease pump for use in transfer applications. These pumps can be used with all types of grease up to NLGI-2.

Pumps are available for horizontal mounting on grease totes and grease bags and they include an adaptor to fit a 3" cam-lock adaptor. They can be used with 400 lb (185 kg) drums when mounted to air pneumatic inductor (see «Grease pump systems» section in this chapter.)



FLUIDS HANDLED

- Grease up to NLGI-2.

MARKETS SERVED

- Mining and construction.
- In-plant grease transfer.
- Railroad and mass transit.

MODELS		
PART No.	APPLICATION	WEIGHT
532 131	Bulk tote, includes 3" cam-lock adaptor	39 lb (19 kg)

TECHNICAL DATA	
Pump ratio	12:1
Continuous duty flow rate	33 lb/min (15 kg/min)
Maximum free flow	88 lb/min (40 kg/min)
Air pressure operating range	20 - 100 psi (1,5 - 7 bar)
Maximum outlet pressure	1,200 psi (84 bar)
Air motor effective diameter	6" (150 mm)
Air motor stroke	4" (100 mm)
Air consumption (1)	39 scfm (1.100 NI/min)
Air inlet	1/2" NPTF
Fluid outlet	1" NPTF
Wetted and seal materials	Cast Iron / Steel / Hard chromed steel / UHMWPE / NBR / PTFE / Polyurethane
Noise level (2)	80 dB
Manual	853 816

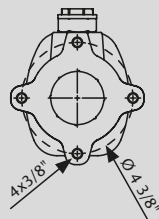

(1) Air consumption at 70 psi (5 bar) air pressure, NLGI-2 grease at 68 °F (20 °C) and 60 cpm.
 (2) Noise level measured at 3' (1 m) from the pump, 100 psi (7 bar) air pressure and free delivery.

DIMENSIONS Inches - (mm)	
PART No.	532 131
A	29" (742)
B	20" (516)
C	2 3/4" (70)
D	9" (226)
E	5 3/4" (146)

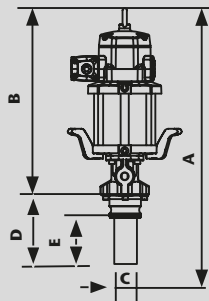

NLGI-2, 70 °F (21 °C) CAPACITY CURVE

