

High flow double acting pumps with high pressure delivery for use in lubrication systems that require a combination of high flow and pressure delivery. Pumps can be used with grease up to NLGI-2 viscosity. These pumps can be used in medium length systems that include simultaneous operation outlets.

Pumps are available for cover mount to 120 lb (50 kg) and 400 lb (185 kg) open drums and for horizontal and side mount on grease totes, bags and tanks.



#### FLUIDS HANDLED

- Grease up to NLGI-2.

#### MARKETS SERVED

- Heavy-Duty service shops.
- Fleets.
- Mining and construction.
- Railroad and mass transit.
- In-plant.
- Marine.

#### MODELS

PART No.	APPLICATION	WEIGHT
531 411	400 lb (185 kg) drum, flange mounted.	55 lb (25 kg)
531 421	120 lb (50 kg) drum, flange mounted.	49 lb (22 kg)
531 431*	Bulk tote	57 lb (26 kg)

\* Includes adaptor 753 110 to fit a 3" cam-lock connector for use with totes, grease bags and tanks.

#### TECHNICAL DATA

Pump ratio	40:1
Continuous duty flow rate	7.5 lb/min (3,5 kg/min)
Maximum free flow	22 lb/min (11 kg/min)
Air pressure operating range	20 - 200 psi (1,5 - 14 bar)
Maximum outlet pressure	8,000 psi (560 bar)
Air motor effective diameter	4 1/2" (115 mm)
Air motor stroke	4" (100 mm)
Air consumption (1)	26.5 scfm (750 NI/min)
Air inlet	1/2" NTPF
Fluid outlet	1/2" NTPF
Wetted and seal materials	Cast Iron / Steel / Hard chromed steel / UHMW PE / NBR / PTFE
Noise level (2)	80 dB
Manual	853 814

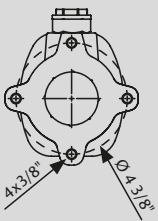

#### DIMENSIONS Inches - (mm)

PART No.	531 411	531 421	531 431*
A	51" (1.357)	43" (1.152)	36 1/2" (992)
B	17 1/2" (502)	17 1/2" (502)	17 1/2" (502)
C	2" (50)	2" (50)	2" (50)
D	33 1/2" (855)	25 1/2" (650)	19" (490)
E	-	-	16" (410)

- (1) Air consumption at 70 psi (5 bar) air pressure, NLGI-2 grease at 68 °F (20 °C) and 80 cpm.  
 (2) Noise level measured at 3' (1 m) from the pump, 100 psi (7 bar) air pressure and free delivery.

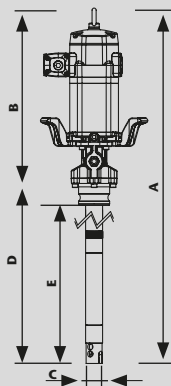

#### NLGI-2, 70 °F (21 °C) CAPACITY CURVE

