

**1100 SERIES PRE-SET PISTOL GRIP METER
METRO MECÁNICO DE 1100 SERIES
MÈTRE MÉCANIQUE DE 1100 SÉRIES**

Parts and Technical Service guide
Guía de servicio técnico y recambio
Guide d'instructions et pièces de rechange

Ref.: **1100 SERIES PRE-SET
Pistol Grip 1152, 1153,
1154, 1155**

Description/ Descripción/ Description

E

This High Quality one-piece Pre-Set Pistol Grip style Mechanical Meter is intended for use with SAE 5 to 50 Motor Oils, SAE 80 to 240 Gear Oils and Ethylene Glycol. Available for dispensing in Litres, Quarts and Gallons. Non-resettable totalizer included with all versions. Sleeve type swivel and outlet pipe/hose included with standard Models.

SP

Esta alta calidad de una sola pieza preestableció el estilo que el metro mecánico se piensa para el uso con aceites del motor del SAE 5 a 50, aceites del apretón de la pistola del engranaje del SAE 80 a 240 y glicol de etileno. Disponible para dispensar en litros, cuartos de galón y galones. totalizador No-restaurable incluido con todas las versiones. Envuelva el eslabón giratorio y el enchufe pipe/hose del tipo incluidos con los modelos estándares.

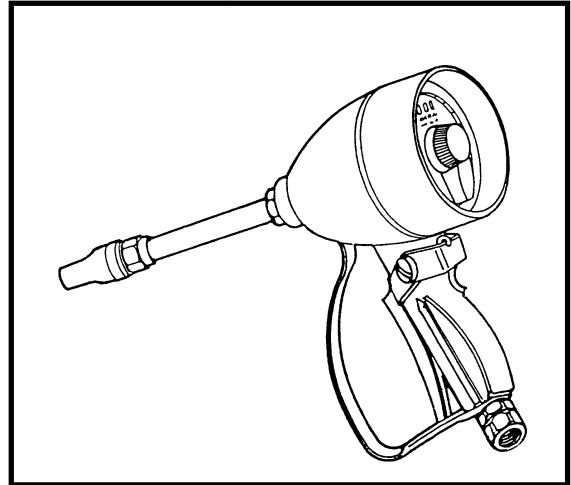

FR

Cette haute qualité d'une seule pièce a pré-régulé le modèle de poignée de pistolet le mètre que mécanique est prévu pour l'usage avec des huiles de moteur de SAE 5 à 50, huiles de vitesse de SAE 80 à 240 et éthylène-glycol. Disponible pour distribuer en litres, quarts et gallons. totalisateur Non-réglable inclus avec toutes les versions. Gagnez le pivot et la sortie pipe/hose de type inclus avec les modèles standard.

Installation - Operation/ Instalación – Modo de empleo/ Installation – Mode d'emploi

E

Attach the Swivel to the meter inlet using Loctite #242 (provided). Attach outlet pipe/hose to the outlet of the meter using Loctite #242 (provided). Mount the meter to the dispensing hose using Loctite #242 (provided). Bleed all air from the dispensing line and confirm proper operation with a sample dispense.

SP

Una el eslabón giratorio a la entrada del metro. Una el enchufe pipe/hose al enchufe del metro. Monte el metro a la manguera que dispensa. Sangre todo el aire de la línea.

FR

Attachez le pivot à l'admission de mètre. Attachez la sortie pipe/hose à la sortie du mètre. Montez le mètre au tuyau de distribution. Saignez tout l'air de la ligne.

1100 PS | 1

✂ Repair Kits/ Kits de Reparación ✂

Individual/Separate internal Meter Repair parts not available, diagram for reference only.

Model Number	Units of Measure
1152	60 Quart - Gallon Totalizer
1153	60 Gallon - Gallon Totalizer
1154	16 Quart - Gallon Totalizer
1155	60 Liter - Liter Totalizer

Parts Available Separately	Description
1129	Swivel
1128	Universal Flex 90° Outlet
1131	Gear Oil Outlet
1135	Straight Flex Outlet
1139	Rigid Bent Oil Outlet
1141	Rigid Straight Outlet
1137	Manual Drip Tip
1138	Semi-Auto Drip Tip

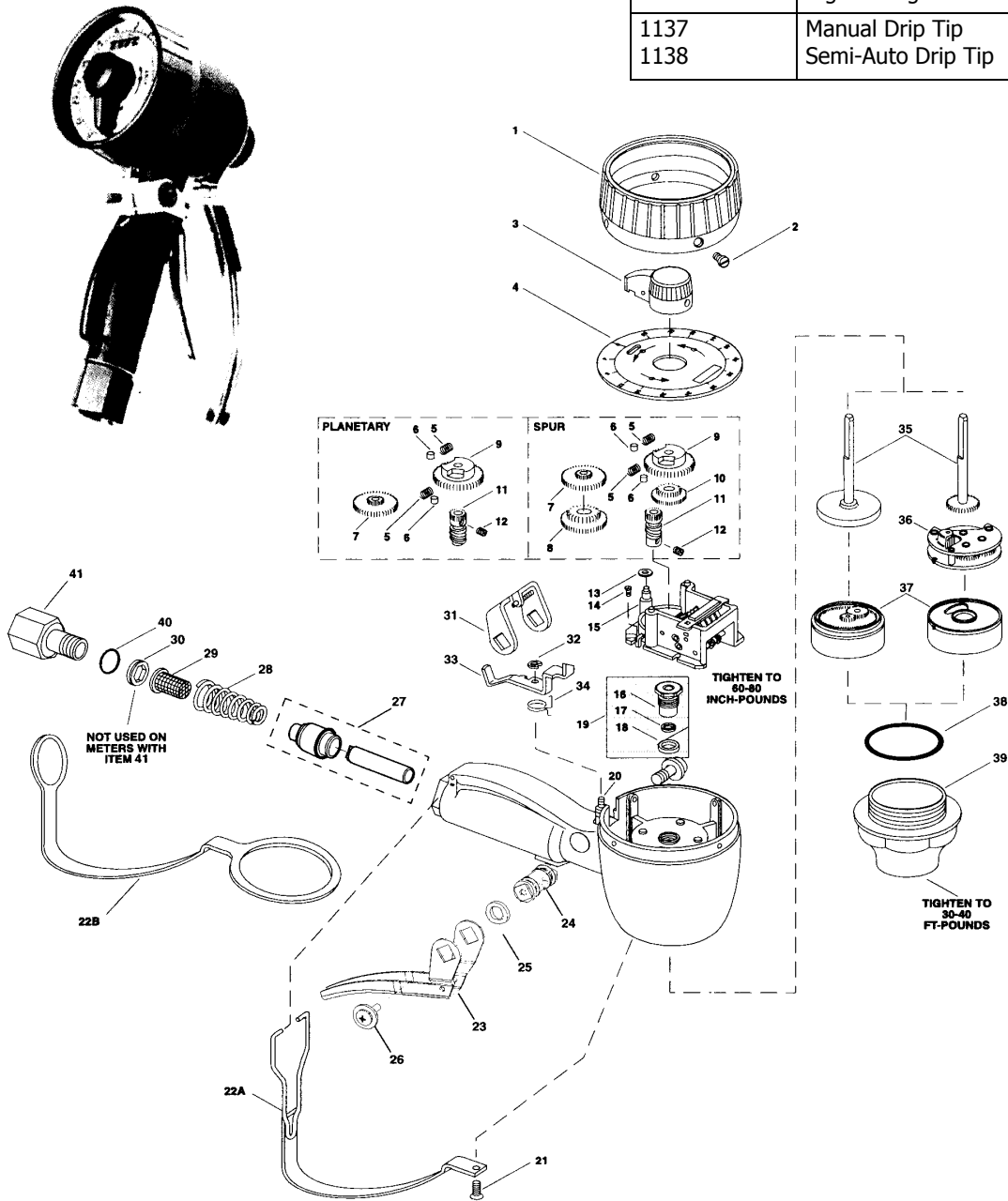

Troubleshooting/ Anomalías y sus soluciones

Symptoms	Possible Reasons	Solutions
Leaks from threads.	Assembly/Mounting with inferior thread sealing compounds.	Reseal threads with Loctite Blue #242 or equivalent product.
Pointer does not turn or turns unevenly.	Bent drive shaft (35) or damaged pointer (3).	Replace affected parts. (7/64 ALLEN)
Meter is inaccurate.	Screen (29) Clogged.	Close upstream ball valve or disconnect pump and relieve system pressure. Remove the swivel and screen, clean and reassemble.
	Bent drive shaft (35) or damaged pointer (3).	Replace affected parts. (7/64 ALLEN)
	Release Screw (31)	Adjust the Release Screw.
Meter will not shut off.	Valve Assembly (27) damaged or obstructed.	Close upstream ball valve or disconnect pump and relieve system pressure. Disassemble meter and clean all parts. Replace any that are damaged.
	Release Trigger (33) bent	Realign or replace.
Oil flow diminished. No oil flow.	Screen (29) Clogged.	Close upstream ball valve or disconnect pump and relieve system pressure. Remove the swivel and screen, clean and reassemble.
Pointer turns freely in both directions.	Clutch Roller (6) or Clutch Spring (5) or Pointer Assembly (3) damaged.	Replace affected parts. (7/64 ALLEN)
	Older Meters have a rubber Clutch Spring (5)	Update with steel Clutch Spring. (7/64 ALLEN)
Meter Handle frozen. Meter leaks at Handle pivot.	Plastic Cam (24) and Valve Assembly (27) broken – (discontinued).	Update the Cam and Valve assembly with steel parts.
	Quad Rings (25) defective.	Replace.

Technical data/ Datos técnicos

Maximum Fluid Pressure	Presión de fluido máxima		70 bar (1000 psi)
Minimum Flow	Flujo Mínimo		1.5 l/min (.4 GPM)
Maximum Flow	Flujo Máximo		15 l/min (4 GPM)



Distributed By: